



APP Reconfigure Procedure

Metra PowerSports® Technical Bulletin MPS-RZ1RGB APP Reconfigure

Upon first connection with a APPLE® device the MPS-RZ1RGB users may experience a condition where the APP will lock up. If this occurs apply the reconfigure fix.

1. Verify the APP connection, and RGB function is on

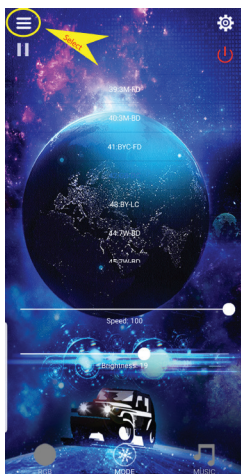

2. Open Settings -> Select Chip Setting -> Set Pix Number -> 45

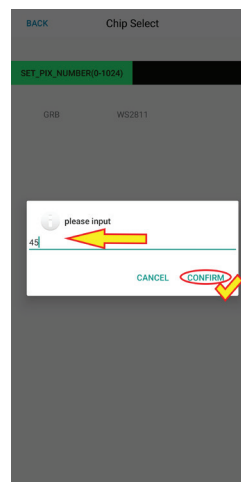

3. Enter 45 -> Confirm -> OK -> Verify operation

