



Data Interface with SWC

Fits Select Volkswagen Models 2002-2016

INTERFACE FEATURES

Designed for amplified and non-amplified systems

- Provides accessory power (12-volt 10-amp)
- Retains R.A.P. (Retained Accessory Power)
- Provides NAV outputs (parking brake, reverse, and speed sense)
- Built-in features like SWC & Auto-Detect
- Auto-detect feature - automatically detects the vehicle type, radio connection, and preset controls
- Ability to dual assign steering wheel control buttons
- Designed to work with a major radio brands
- Can be manually programmed for most vehicles
- Retains settings, even after battery disconnection
- Provides 12-volt illumination output
- Excludes Fender® audio systems
- Micro “B” USB updatable

APPLICATIONS

Volkswagen

Beetle.....	2012-2015	Golf.....	2002-2014	Rabbit.....	2006-2009
CC.....	2009-2014	GTI.....	2002-2014	Tiguan.....	2009-2015
Eos.....	2006-2016	Jetta.....	2002-2015		
GLI.....	2008-2012	Passat.....	2002-2014		

Product Info



TABLE OF CONTENTS

Connections.....	2
Programming.....	3
Troubleshooting.....	4

INTERFACE COMPONENTS

- AXTC-VW1 interface
- AXTC-VW1 harness
- 3.5mm adapter

TOOLS & INSTALLATION ACCESSORIES REQUIRED

- Crimping tool and connectors, or solder gun, solder, and heat shrink
- Tape
- Wire cutter
- Zip ties

ATTENTION: With the key out of the ignition, disconnect the negative battery terminal before installing this product. Ensure that all installation connections, especially the air bag indicator lights, are plugged in before reconnecting the battery or cycling the ignition to test this product.

NOTE: Refer also to the instructions included with the aftermarket accessory before installing this device.

CONNECTIONS

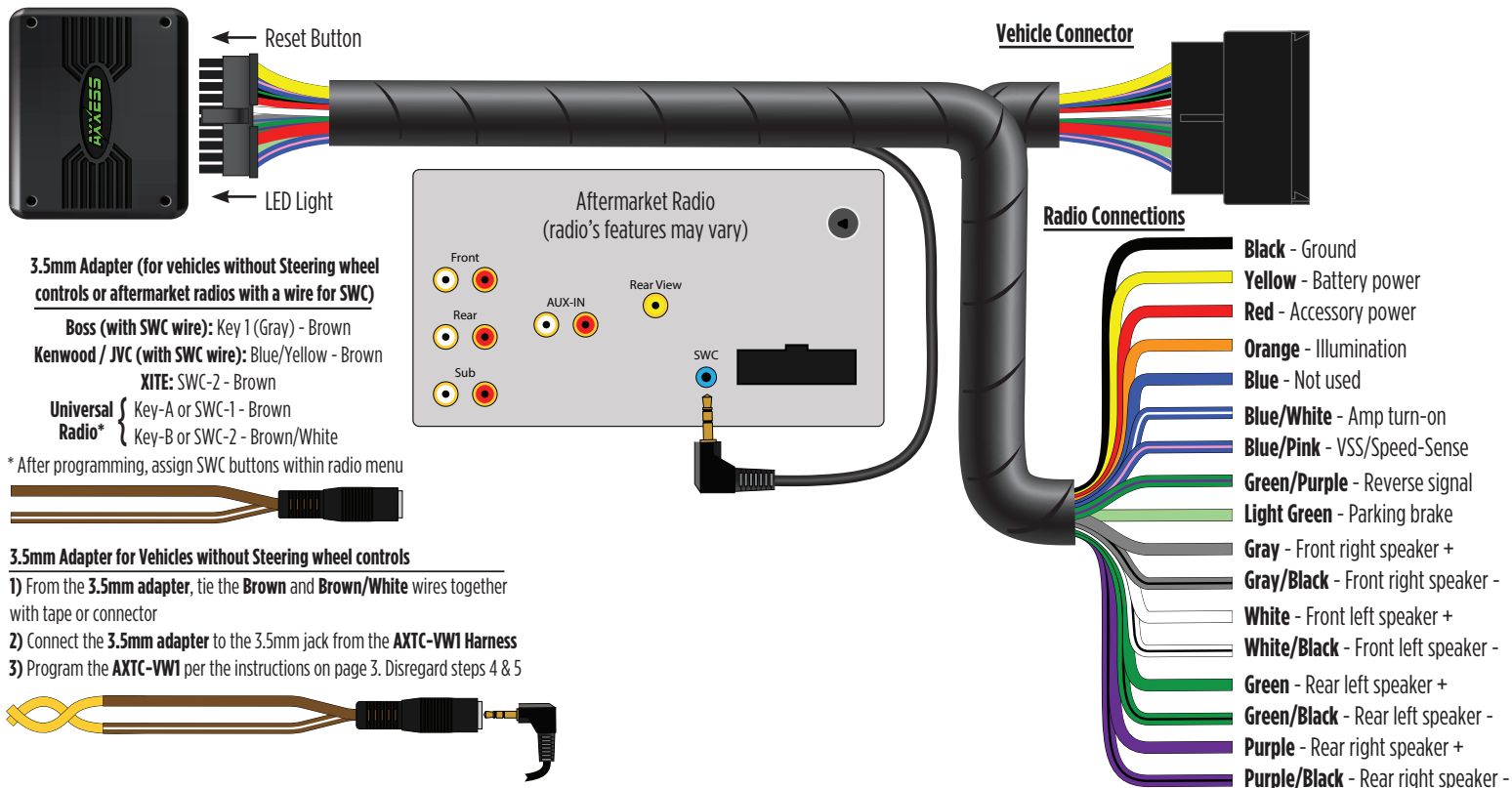

PROGRAMMING

- 

1. Open the driver's door, and keep open during the programming process.
- 

2. Cycle the ignition on.
- 

3. Connect the **AXTC-VW1 harness** to the **AXTC-VW1 interface**, and then to the wiring harness in the vehicle.
- 

4.* Tap **Volume Up**. Locate the **Volume Up** button on the the steering wheel. Program the interface by tapping the **Volume Up** button at a heartbeat pace until the LED light stops flashing.

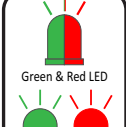
*Only applicable if vehicle came with steering wheel controls
- 

5.* The LED light will flash **Green & Red** while the interface programs the radio to the steering wheel controls. Once programmed, the LED light will go out, then produce a pattern which will identify the radio type installed. Refer to the **Radio LED Feedback** section under **Troubleshooting** for radio types.

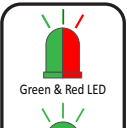
*Only applicable if vehicle came with steering wheel controls
- 

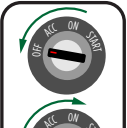
6. The LED light will go out, then once again quickly flash **Green & Red** while the interface programs itself to the vehicle. Once programmed, the LED light will go out again, then turn solid **Green**.
- 

7. Cycle the ignition off, then back on.
- 

8. Test all functions of the installation for proper operation.

Note: Audio Mode must be selected in the MFI menu to allow track up and down to function. Refer to the vehicle owner's manual for more information.

TROUBLESHOOTING

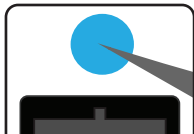
- 

If the interface fails to function, press and release the reset button, then repeat the programming process from step 4 to try again.

LED Light Reset Button

QR Code Scan Here



Further troubleshooting steps and information can be located at:

axxessinterfaces.com/product/AXTC-VW1

- ### Final LED Feedback

At the end of programming the LED light will turn **Solid Green** which indicates programming was successful. If the LED light didn't turn **Solid Green**, reference the list below to understand which programming section the problem may stem from.

LED Light	Radio Programming Section	Vehicle Programming Section
Solid Green	Pass	Pass
Slow Red Flash	Fail	Pass
Slow Green Flash	Pass	Fail
Solid Red	Fail	Fail

Note: If the LED light shows **Solid Green** for **Pass** (indicating everything programmed correctly), yet the steering wheel controls don't work, check to ensure that the 3.5mm jack is plugged in, and also plugged into the correct jack on the radio. Once corrected, press the reset button, then program again.

Having difficulties? We're here to help.



Contact our Tech Support line at:

386-257-1187



Or via email at:

techsupport@metra-autosound.com

Tech Support Hours (Eastern Standard Time)

Monday - Friday: 9:00 AM - 7:00 PM

Saturday: 10:00 AM - 5:00 PM

Sunday: 10:00 AM - 4:00 PM



**Metra recommends MECP
certified technicians**