



Fits Toyota **RAV4** 2006-2012

Visit MetraOnline.com for more detailed information about the product and up-to-date vehicle specific applications

KIT FEATURES

- Stereo installation kit designed to fit any standard 2" or 4" tall aftermarket radio utilizing our patented quick-release, snap-in ISOmount system with custom trim ring
- Painted scratch-resistant matte black
- Made from the highest quality ABS plastic for an original factory-like fit and finish

KIT COMPONENTS

- A) Radio housing • B) ISO Snap in brackets • C) Trim plate • D) Double DIN brackets • E) Double DIN trim plate • F) Pocket
- G) (2) White panel clips and (2) Yellow panel clips

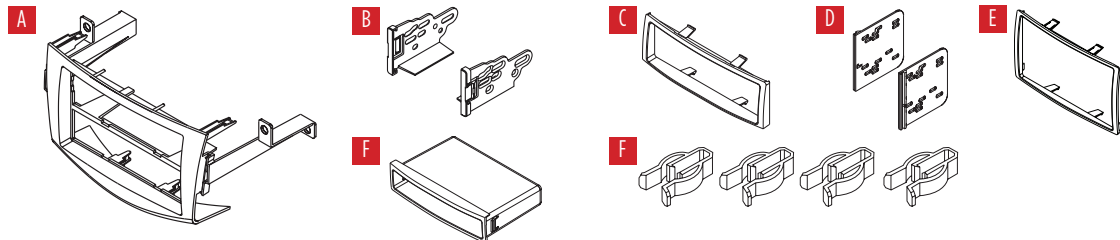

TABLE OF CONTENTS

Dash Disassembly	2
Kit Preparation	3
Kit Assembly	
– DIN radio provision with pocket	4
– ISO radio provision with pocket	5
– Double DIN radio provision	6

WIRING & ANTENNA CONNECTIONS

Wiring Harness: See axessinterface.com for A/V and SWC interface options.

Antenna Adapter: Not required—2006-2011 40-LX11—2012

TOOLS REQUIRED

- Panel removal tool • Phillips screwdriver
- Flat blade screwdriver • Socket wrench

Attention! With the key out of the ignition, disconnect the negative battery terminal before installing this product. Ensure that all installation connections are secure before cycling the ignition to test this product.

DASH DISASSEMBLY

1. Unclip and remove the (2) side panels on the left and right side of the factory radio. (Figure A)
2. Remove (4) 10mm screws securing the radio. (Figure B)

Continue to Kit Preparation

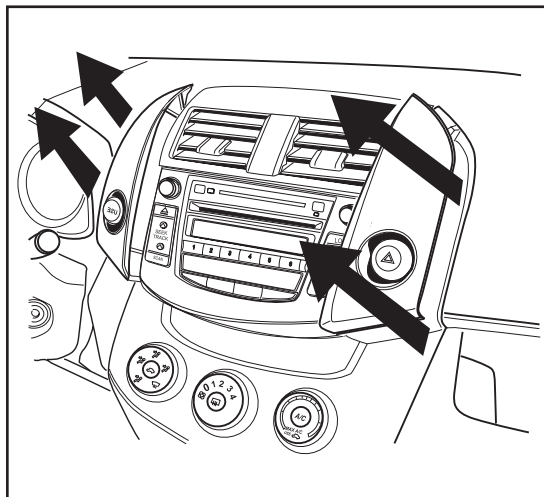

(Figure A)

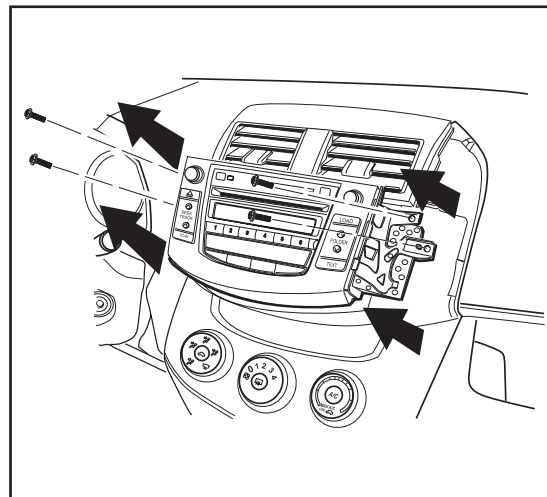

(Figure B)

KIT PREPARATION

1. Attach (2) **white panel clips** and (2) **yellow panel clips** to rear of **radio housing** where shown. (Figure A)

Note: OEM factory clips can also be used.

Continue to kit assembly

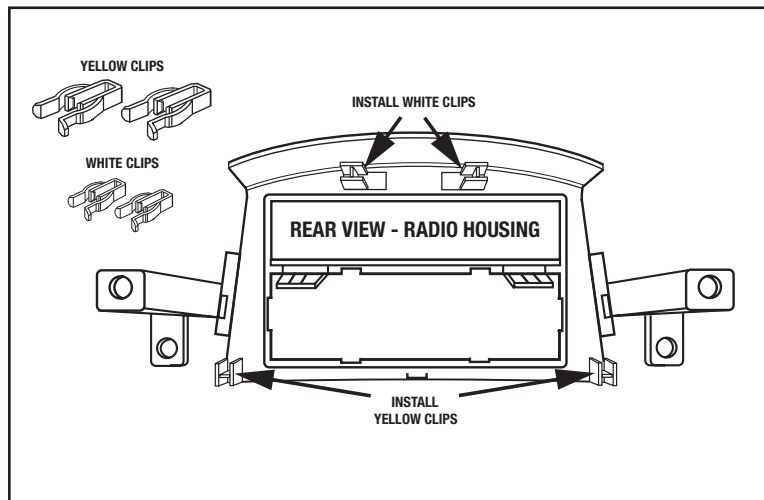

(Figure A)

KIT ASSEMBLY

DIN radio provision with pocket

1. Slide the DIN cage into the **radio housing** and secure by bending the metal locking tabs outward. (Figure A)
2. Slide the aftermarket radio into the cage until it snaps into place. (Figure B)
3. Snap the **pocket** into the **radio housing**. (Figure C)
4. Locate the factory wiring harness in the dash. Metra recommends using the proper mating adapter from Metra or AXXESS. Re-connect the negative battery terminal and test the unit for proper operation.
5. Reassemble dash in reverse order of disassembly.

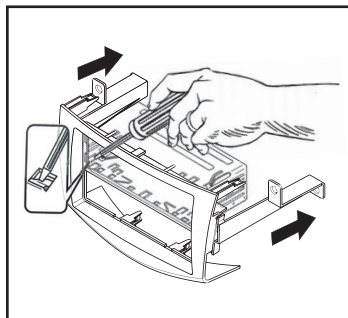

(Figure A)

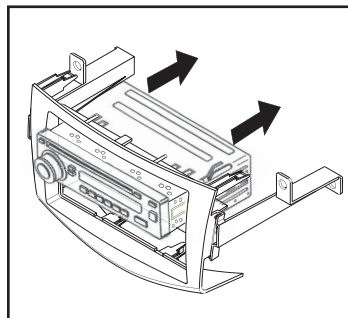

(Figure B)

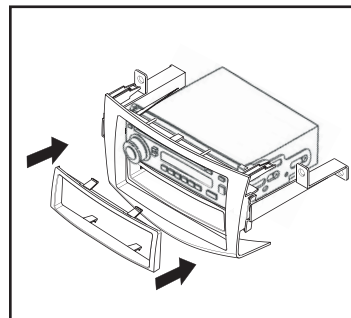

(Figure C)

KIT ASSEMBLY

ISO mount radio provision with pocket

1. Mount the **ISO brackets** to the radio using the screws supplied with the radio. (Figure A)
2. Slide the aftermarket radio into the radio opening until the side clips snap into place. (Figure B)
3. Snap the **pocket** into the radio housing. (Figure B)
4. Snap the **trim plate** onto the front of the radio housing assembly. (Figure C)
5. Locate the factory wiring harness in the dash. Metra recommends using the proper mating adapter from Metra or AXXESS. Re-connect the negative battery terminal and test the unit for proper operation.
6. Reassemble dash in reverse order of disassembly

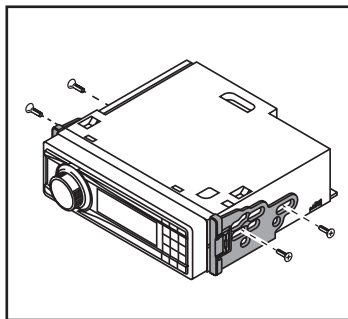

(Figure A)

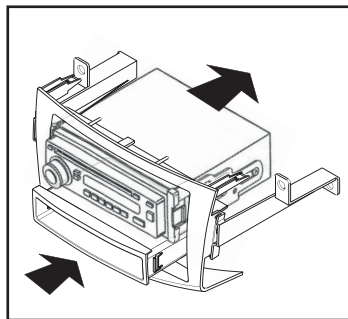

(Figure B)

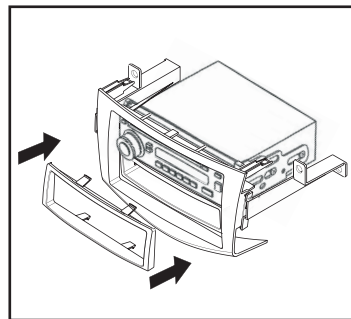

(Figure C)

KIT ASSEMBLY

Double DIN radio provision

1. Cut and remove center divider from **radio housing**. (Figure A)
2. Snap the **Double DIN brackets** to the inside edge of the **radio housing**. (Figure B)
3. Slide the Double DIN radio into the Double DIN bracket/radio housing assembly and secure the radio to the assembly using the screws supplied with the radio. (Figure C)
4. Snap the **Double DIN trim-plate** onto the front of the housing/radio assembly. (Figure C)

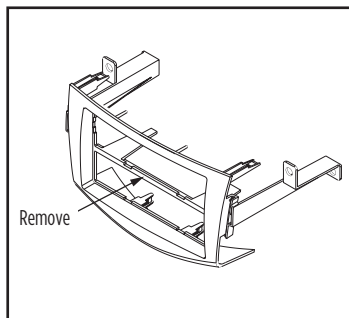

(Figure A)

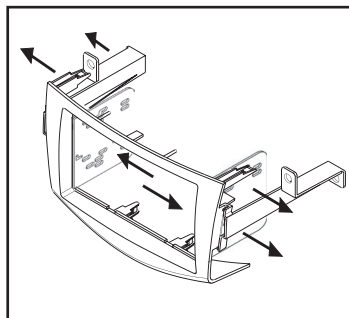

(Figure B)

5. Locate the factory wiring harness in the dash. Metra recommends using the proper mating adapter from Metra or AXCESS. Re-connect the negative battery terminal and test the unit for proper operation.
6. Reassemble dash in reverse order of disassembly.

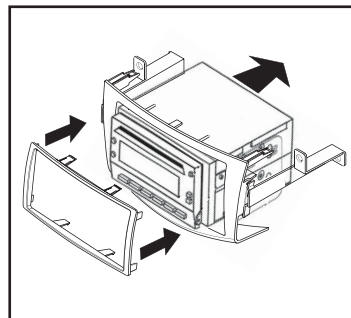

(Figure C)

[illegible]



99-8217
INSTALLATION INSTRUCTIONS



Having difficulties? We're here to help.



Contact our Tech Support line at:

386-257-1187



Or via email at:

techsupport@metra-autosound.com

Tech Support Hours (Eastern Standard Time)

Monday - Friday: 9:00 AM - 7:00 PM

Saturday: 10:00 AM - 5:00 PM

Sunday: 10:00 AM - 4:00 PM



**Metra recommends MECP
certified technicians**